

Tailored Vents



Insert



Flush with Frame



Adjustable Damper



Base Vent



One Directional Vent



One Piece Flush Model



One Piece Insert Model



Grid Style

To Order:

800.347.4745

1609 Halbur Road • Marshall, MN 56258

Tailored Vents Flush With Frame

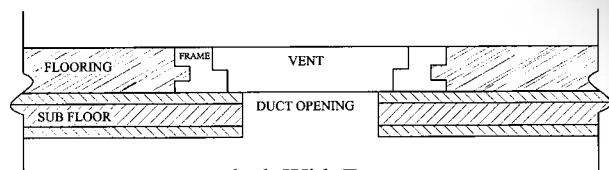
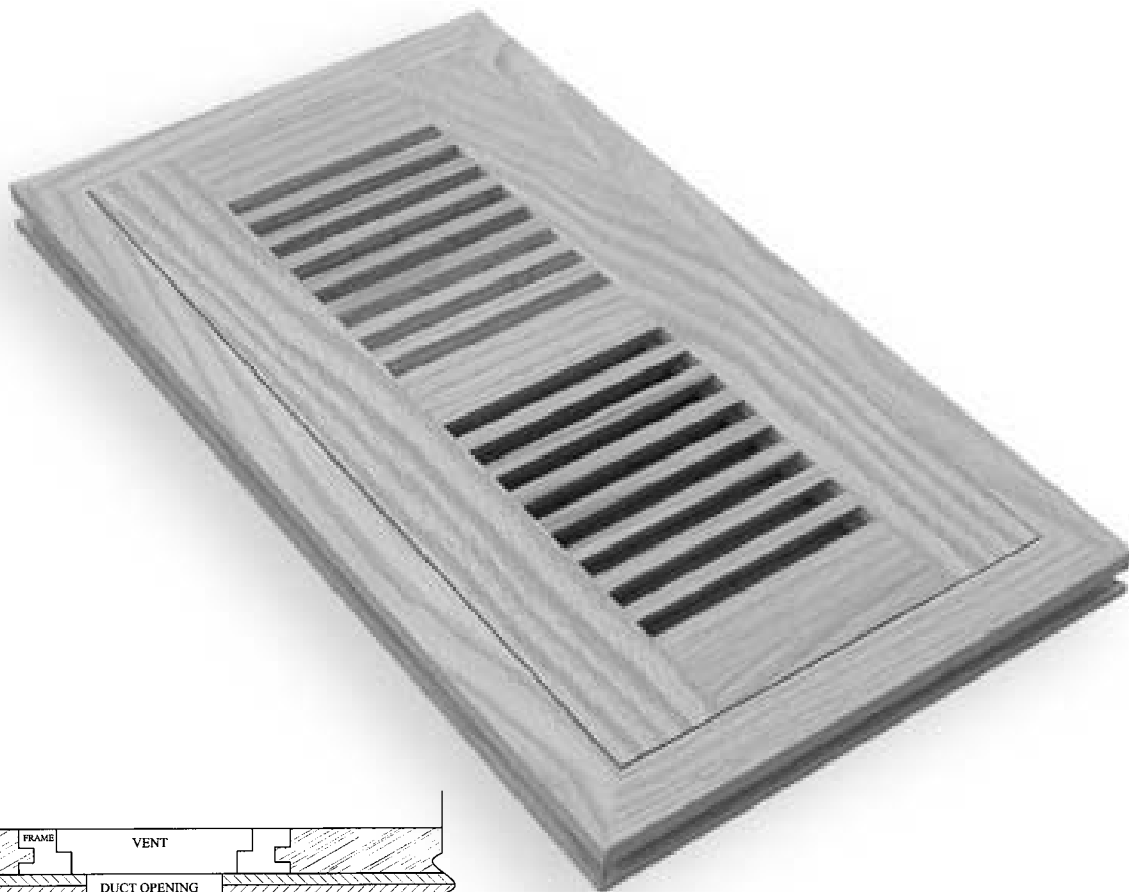

Flush With Frame

Slim, trim, flush styling with the cleanest look possible. Sets flat on the subfloor. The frame is installed permanently while the vent lifts out to permit cleaning of the duct throat. Delicate looking, but tough. **Adjustable damper also available.**

ORDER SIZE (Duct Opening Inches)	FREE AREA (Square Inches)	OVERALL DIMENSIONS With Frame Model
2-1/4 x 10	9	5-3/4 x 13-1/2
2-1/4 x 12	11-1/4	5-3/4 x 15-1/2
2-1/4 x 14	13-1/2	5-3/4 x 17-1/2
4 x 8	11	7-1/2 x 11-1/2
4 x 10	15	7-1/2 x 13-1/2
4 x 12	18-1/4	7-1/2 x 15-1/2
4 x 14	22	7-1/2 x 17-1/2
6 x 10	24-3/4	9-1/2 x 13-1/4
6 x 12	31	9-1/2 x 15-1/2
6 x 14	37	9-1/2 x 17-1/2

Tailored Vents Insert Model

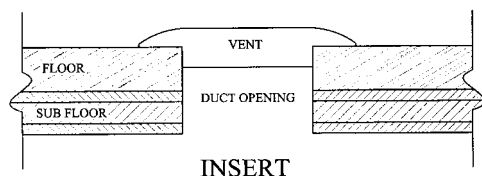
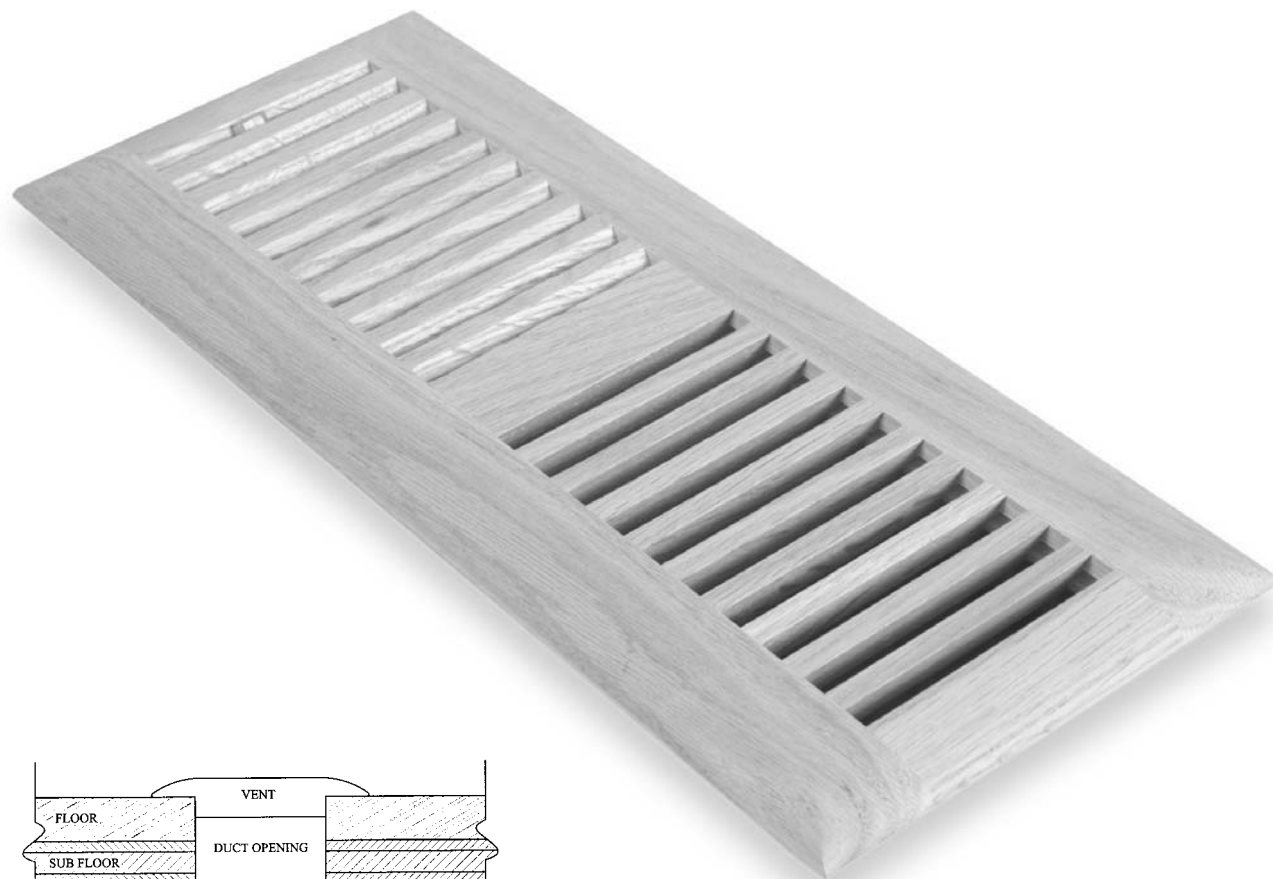

Insert vents REPLACE the metal register. Cleanly designed with a solid, self-rimming lip to conceal inexact cuts in your surface material. **Adjustable damper also available.**

ORDER SIZE (Duct Opening Inches)	FREE AREA (Square Inches)	OVERALL DIMENSIONS
2-1/4 x 10	9	4-1/4 x 12
2-1/4 x 12	11-1/4	4-1/4 x 14
2-1/4 x 14	13-1/2	4-1/4 x 16
4 x 8	11	6 x 10
4 x 10	15	6 x 12
4 x 12	18-1/4	6 x 14
4 x 14	22	6 x 16
6 x 10	24-3/4	8 x 12
6 x 12	31	8 x 14
6 x 14	37	8 x 16

Tailored Vents Dampers

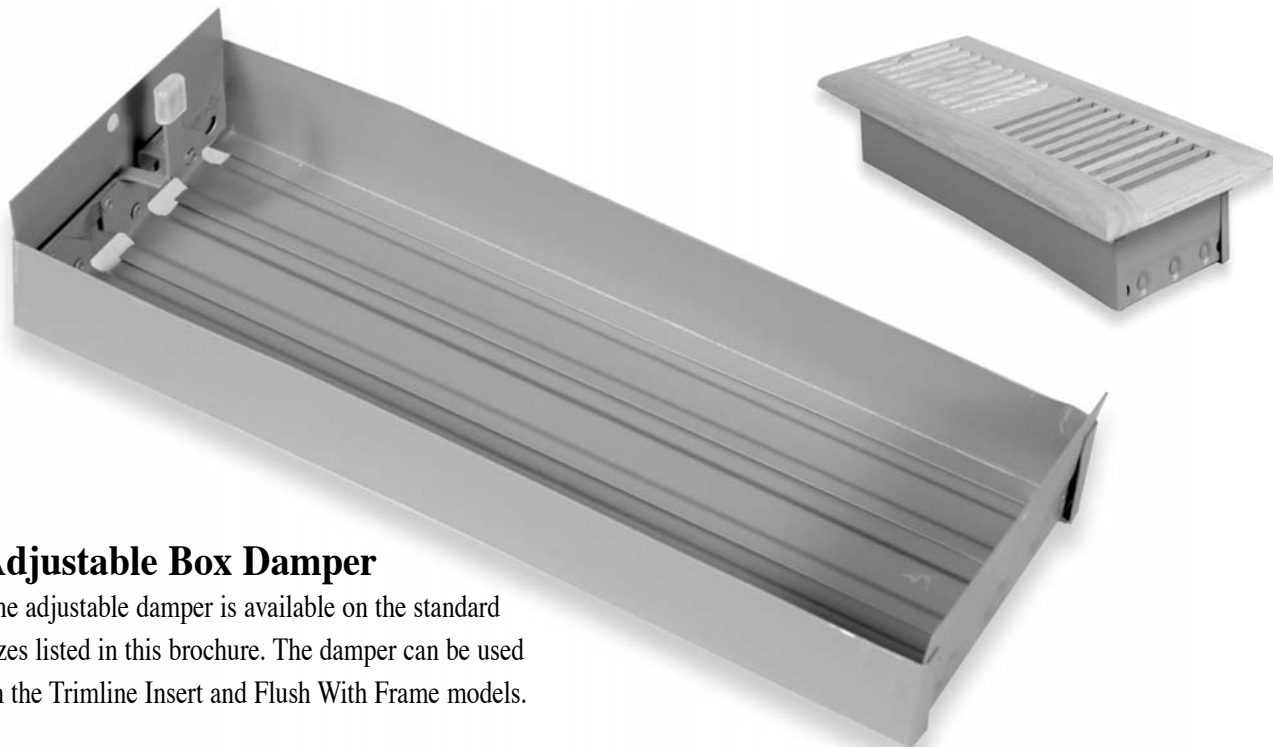

Adjustable Box Damper

The adjustable damper is available on the standard sizes listed in this brochure. The damper can be used on the Trimline Insert and Flush With Frame models.



Easy Slide Damper

The Easy Slide Damper got its name from its simplified function and easy attachment. The plastic damper self attaches to guide rails on the Trimline 4"x10" and 4"x12" Flush With Frame vents. The design allows for airflow control while staying above the duct opening for simplified installation.

Tailored Vents Base Vent

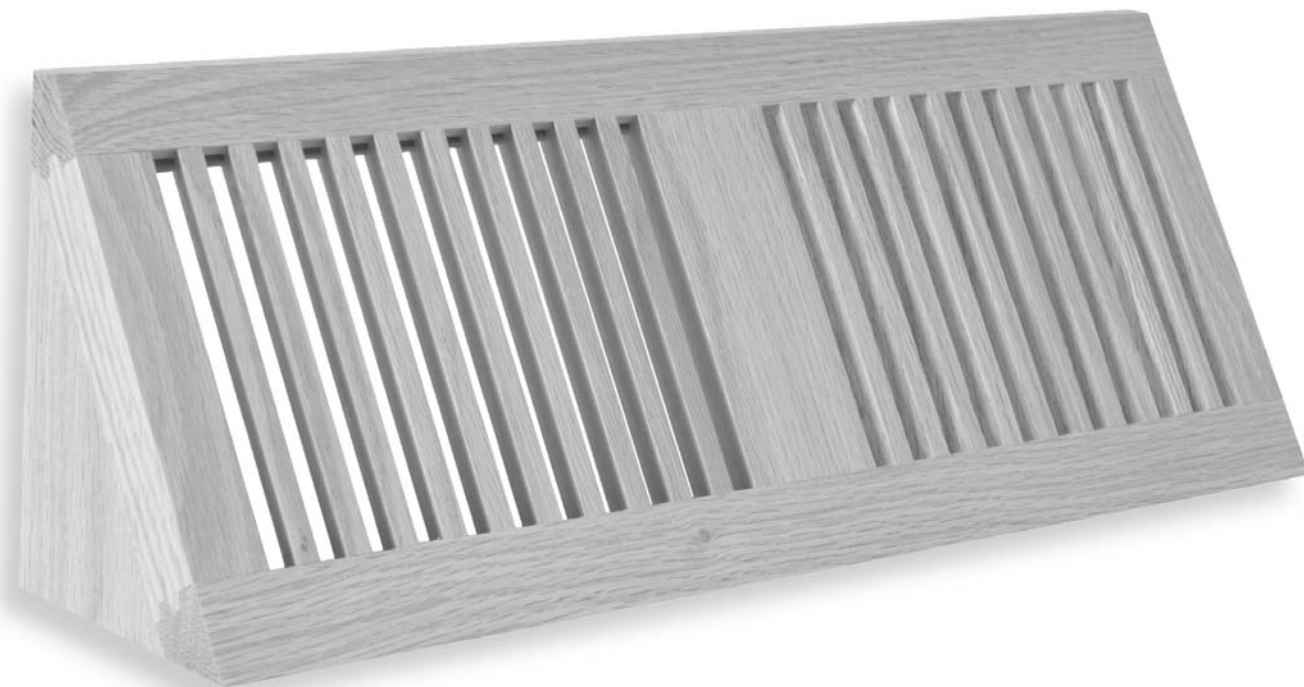

Designed to cover duct openings near the base board - replaces the metal register. The angled face of the base vent covers the entire opening leaving only the detailed craftsmanship to be admired. Use the overall dimensions to determine the size you need to cover opening. Allow 3/4" clearance around all sides of the duct opening. Stock sizes available in trimline. Adjustable damper available in standard sizes.

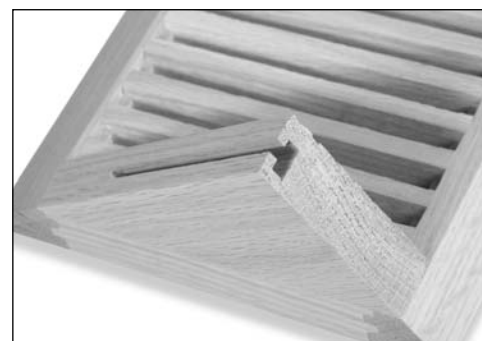

T-slot for easy mounting.

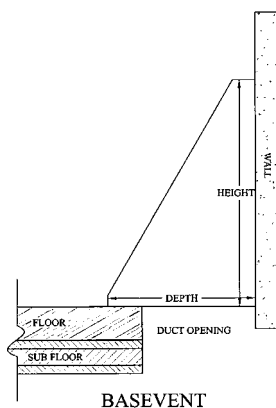

ORDER SIZE (Duct Opening Inches)	FREE AREA (Square Inches)	OVERALL DIMENSIONS
15	24	15 x 5 x 3-1/4
18	28	18 x 5 x 3-1/4

Tailored Vents *Directional Vents* (Wall Applications)

1-Way Directional Vent



The one directional vent is so popular as a custom item we have added two standard sizes in the Flush No Frame model. It is most commonly used in wall mount applications for supply air or return air use. They are available in Flush No Frame or Insert models.

T-slot for easy mounting.
Available upon request.



ORDER SIZE FLUSH NO FRAME (Duct Opening Inches)	FREE AREA (Square Inches)	OVERALL DIMENSIONS
14 x 8	55-1/2	16 x 10
30 x 8	120	32 x 10

3-Way Directional Vent



4-Way Directional Vent



Tailored Vents Grid Style Models

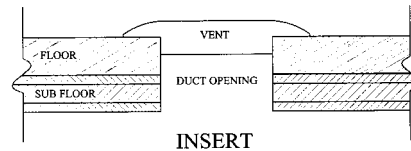
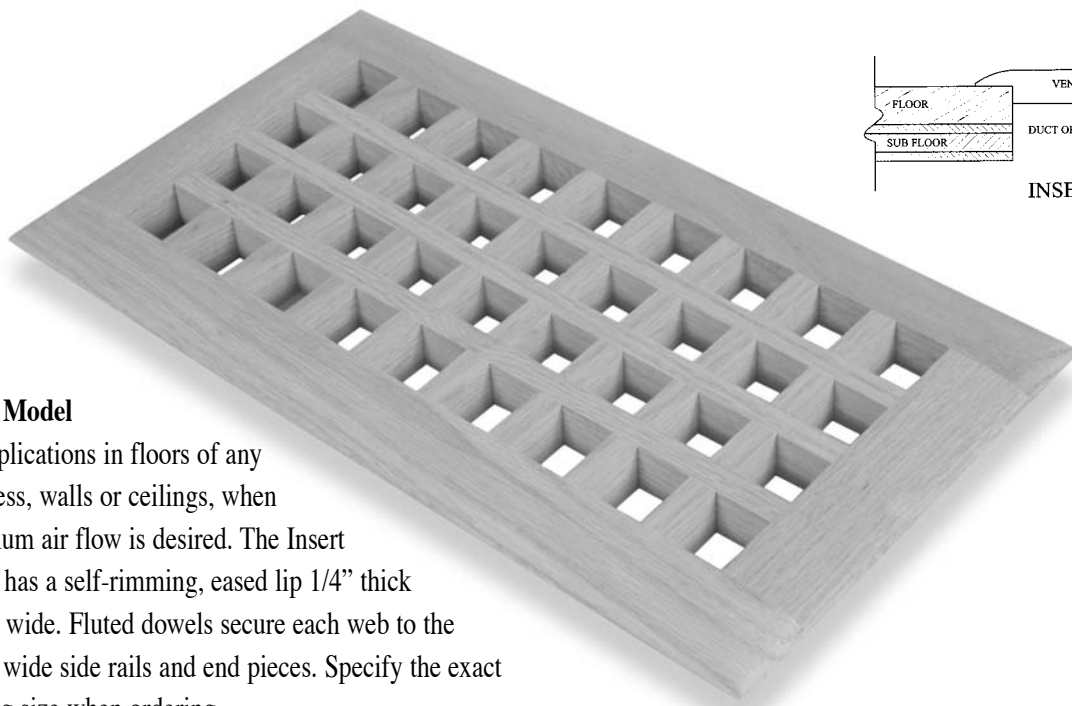

Insert Model

For applications in floors of any thickness, walls or ceilings, when maximum air flow is desired. The Insert Model has a self-rimming, eased lip 1/4" thick and 1" wide. Fluted dowels secure each web to the 1-1/4" wide side rails and end pieces. Specify the exact opening size when ordering.

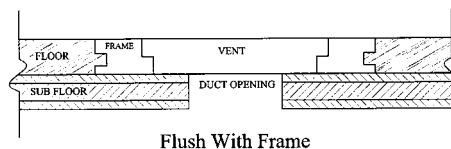
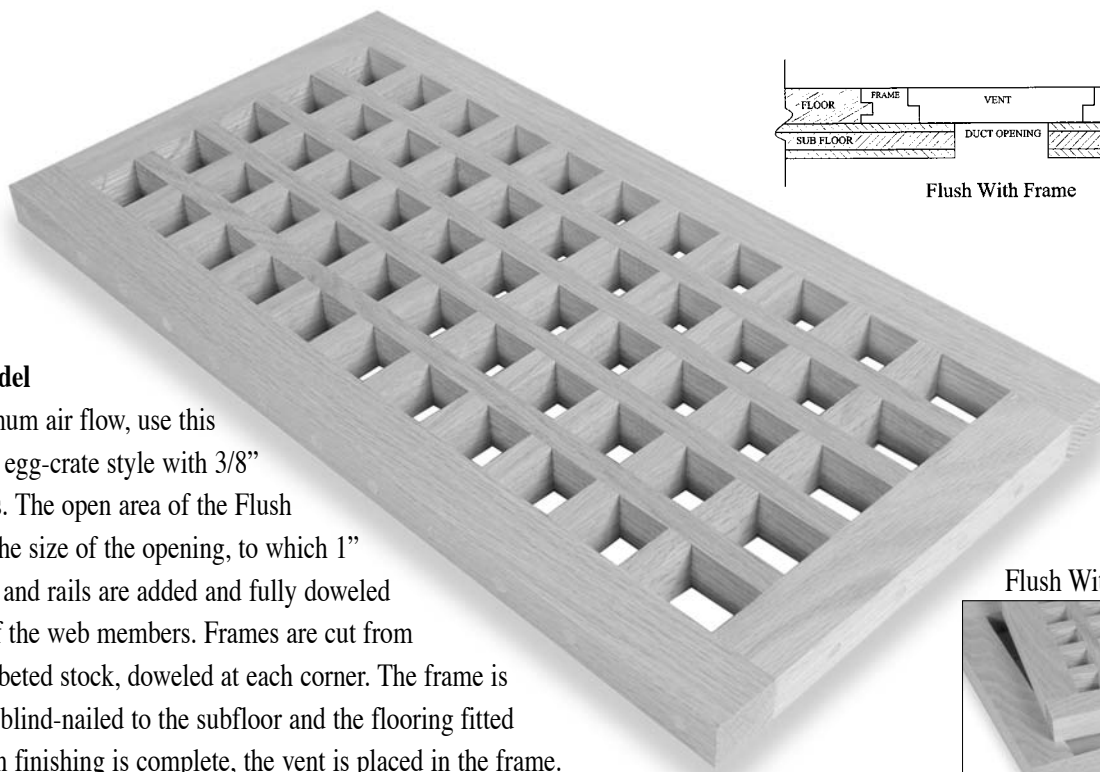

Flush With Frame

Flush Model

For maximum air flow, use this traditional egg-crate style with 3/8" wide webs. The open area of the Flush Model is the size of the opening, to which 1" wide ends and rails are added and fully doweled to each of the web members. Frames are cut from 1-1/4" rabbeted stock, doweled at each corner. The frame is glued and blind-nailed to the subfloor and the flooring fitted to it. When finishing is complete, the vent is placed in the frame. Also available with frame.

Flush With Frame

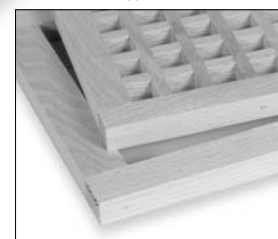

Tailored Vents Round Vents

View of Flush With Frame



Donut Style

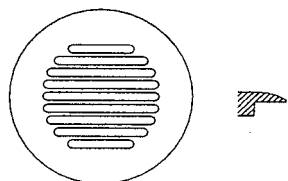
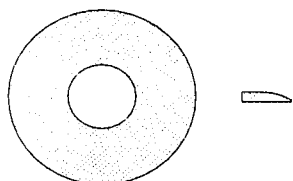
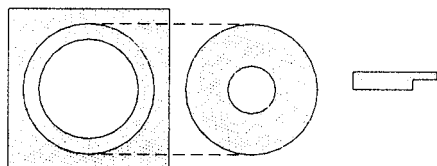

Louvered Style

STYLE	INSERT (Overall Dimension)	FLUSH W/FRAME (Overall Dimension)
Donut Style	5" diameter	6 3/4" square
Louvered Style	5 1/2" diameter	6 3/4" square

Tailored Vents Ceramic Tile Vents

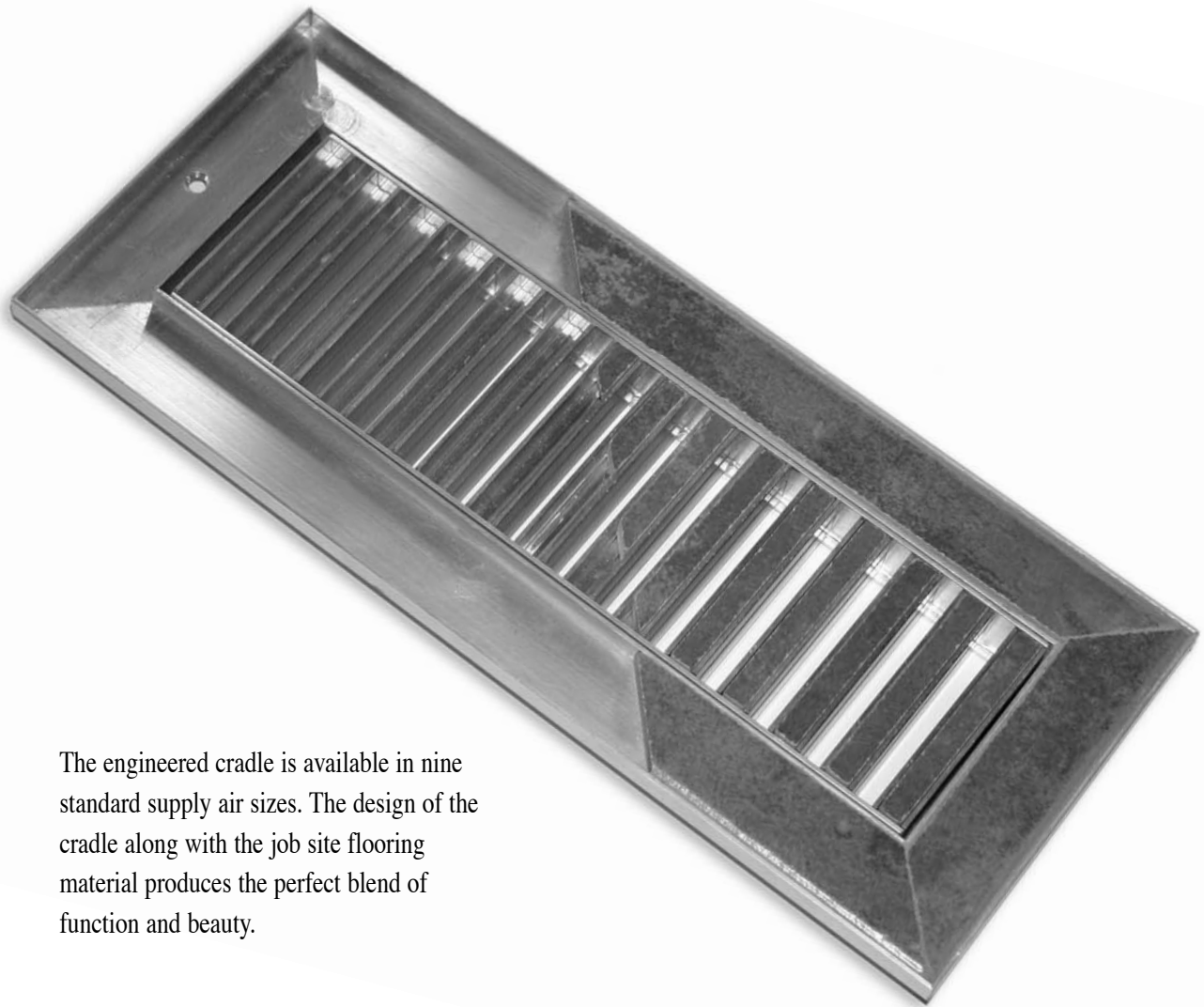

The engineered cradle is available in nine standard supply air sizes. The design of the cradle along with the job site flooring material produces the perfect blend of function and beauty.

SUPPLY AIR SIZE (Duct Opening Inches)

2-1/4 x 10
2-1/4 x 12
2-1/4 x 14
4 x 10
4 x 12
4 x 14
6 x 10
6 x 12
6 x 14

Tailored Vents Brass Vents

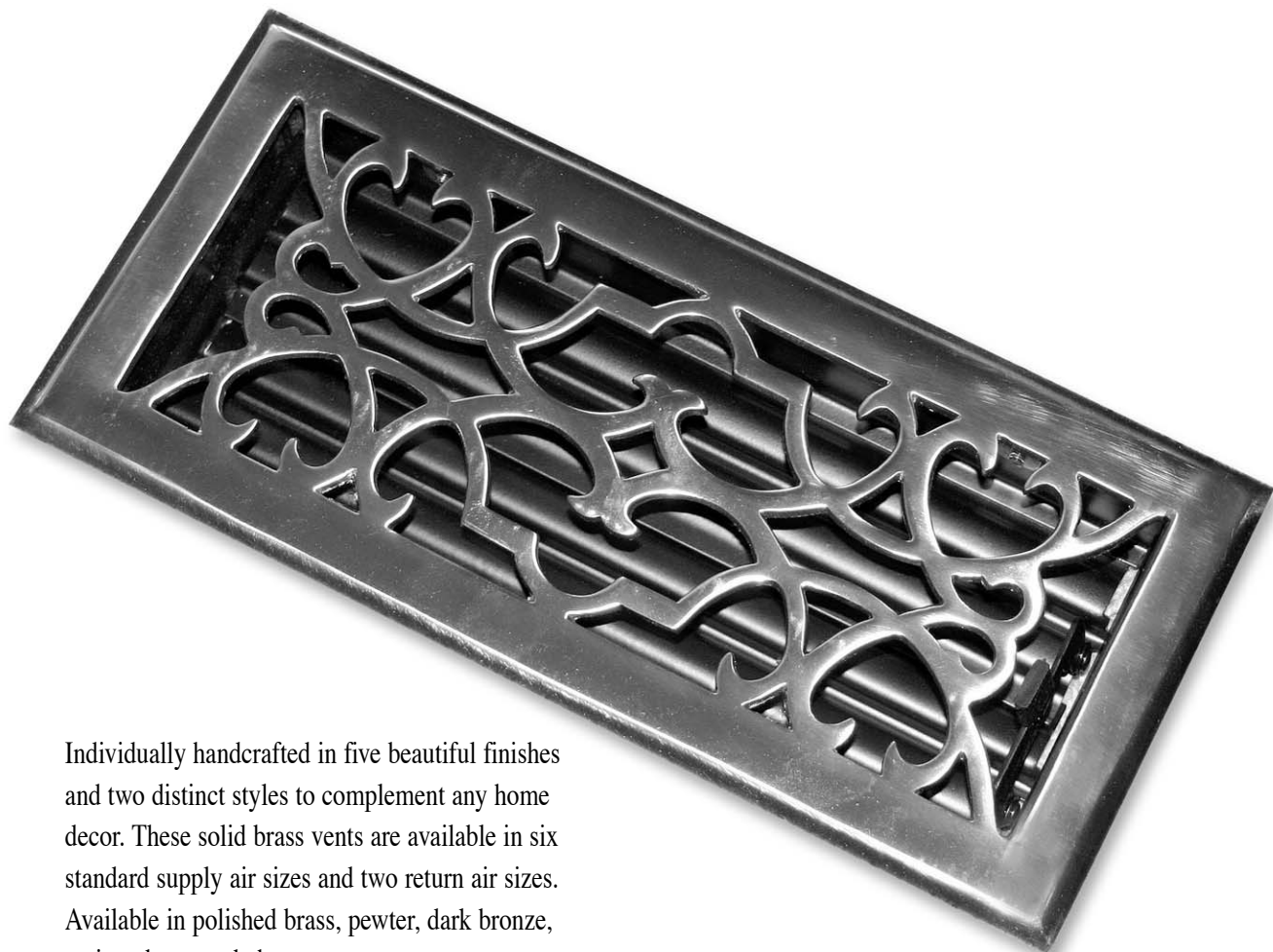

Individually handcrafted in five beautiful finishes and two distinct styles to complement any home decor. These solid brass vents are available in six standard supply air sizes and two return air sizes. Available in polished brass, pewter, dark bronze, antique brass and chrome.

SUPPLY AIR SIZE
(Duct Opening Inches)

2-1/4 x 10

2-1/4 x 12

2-1/4 x 14

4 x 10

4 x 12

4 x 14

6 x 10 Air Return

6 x 12 Air Return

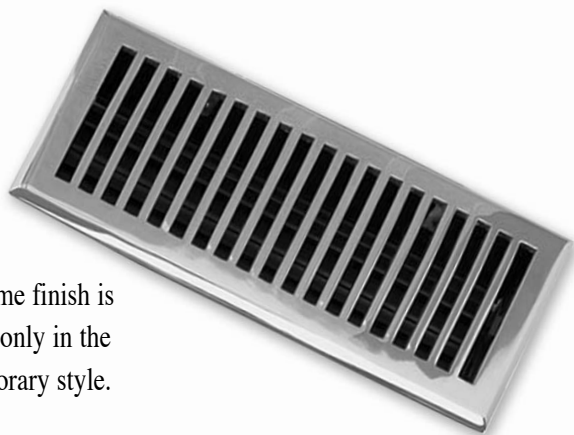

The chrome finish is available only in the Contemporary style.

Available in your choice of Victorian or Contemporary Styles!